

AK-HRP250G/MC Software (Firmware) update procedure

1. Version Information

1. Press the **[SHIFT]** button (A-fig.) and then the **[SHUTTER] (ROP INF)** button (D-fig.). ROR INF Menu is displayed (B-fig.).
2. Turn the **[SELECT]** dial to select menu number “b” (C-fig.).
3. When you press the **[SELECT]** dial button, the version information is displayed.

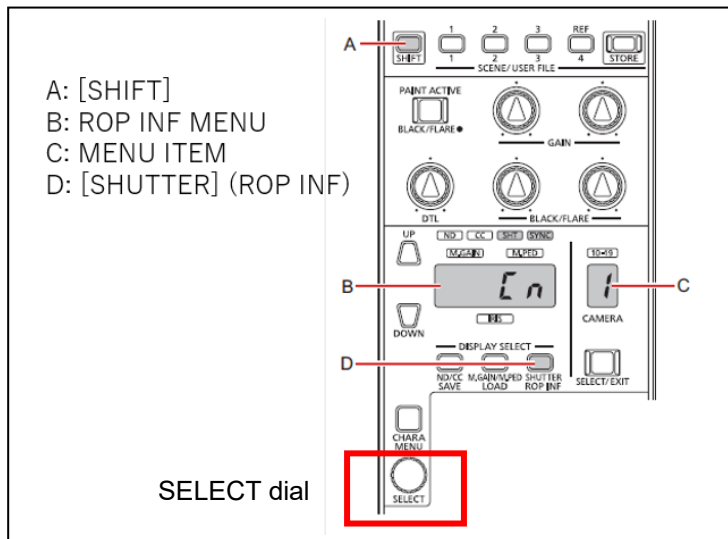

Version Information

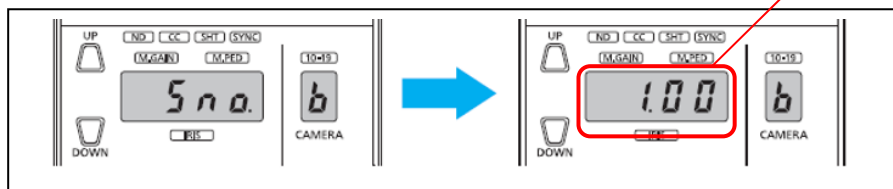

2. Preparation

CAUTION: Before Updating Software

- **Do not power down or pull card while upgrading.** If the program quits during loading, the data will be erased or part writing condition and the restart is not made.
- It is possible to perform an update also with CCU or PoE connection.

< Preparation for SD memory card >

1. Buffer memory size in SD memory card more than 64MB (SD: 64MB to 2GB, SDHC: 4GB to 32GB).
2. Be sure to format SD memory card on the camera recorder.

NOTE: SD card formatted by PC standard formatter will not work.

< Copy the update file >

- 2-1. Accept the software usage agreement and download the update file data “**DV91000****.zip**” for the AK-HRP250 firmware from the following support web site.

[https://pro-av.panasonic.net/en/Support/PASS\(Service Support website\)](https://pro-av.panasonic.net/en/Support/PASS(Service%20Support%20website))

- 2-2. Copy the file “**DV91000****.zip**” to hard disk of your PC and extract the file.

- 2-3. Insert the formatted SD memory card into the PC's card slot.

Then copy the extracted update folder “**PRIVATE**” to the root directory (*1) of the card.

Folder: PRIVATE\MEIGROUP\PAVCN\SBG\SYSCAM\FW\

(*1) : Root directory = top-level directory (i.e., it is not a folder) of the file structure

3. Updated procedure

1. Press the **[SHIFT]** button (A-fig.) and then the **[M.GAIN/M.PED] (LOAD)** button (D-fig.). LOAD Menu is displayed (B-fig.).
2. Turn the **[SELECT]** dial to select menu number “8” (C-fig.). (UP)
3. Insert the SD memory card into the SD memory card slot.

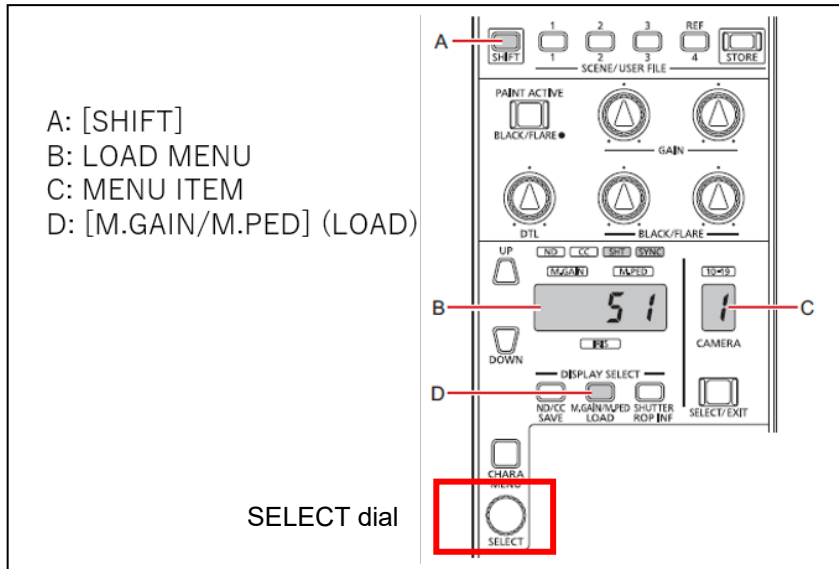

4. Turn the **[SELECT]** dial to select “y” and Press **[SELECT]** dial to confirm selection.

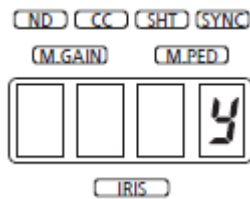

5. While updating, display is blinking on the Setting display (4 digits).

◆ Software update takes approx. a few minutes. Do not power down while updating.

6. When update is completed, “Fin” is displayed and the unit is rebooted automatically.
7. Confirm that the version number is renewed for your confirmation update was correctly done follow the item “1. Version information”.

◆ Error Information

Err6 : Make sure that the memory card is inserted correctly.

Err3/Err : • Make sure the memory card is formatted.

- Check if the memory card is compatible with this unit.
- Make sure that the memory card contains the required data.