

AJ-HPS1500 P2Driver Software Update Procedure

1. Confirmation of Software Version

1. Press the **THUMBNAIL** button to display the thumbnail screen.

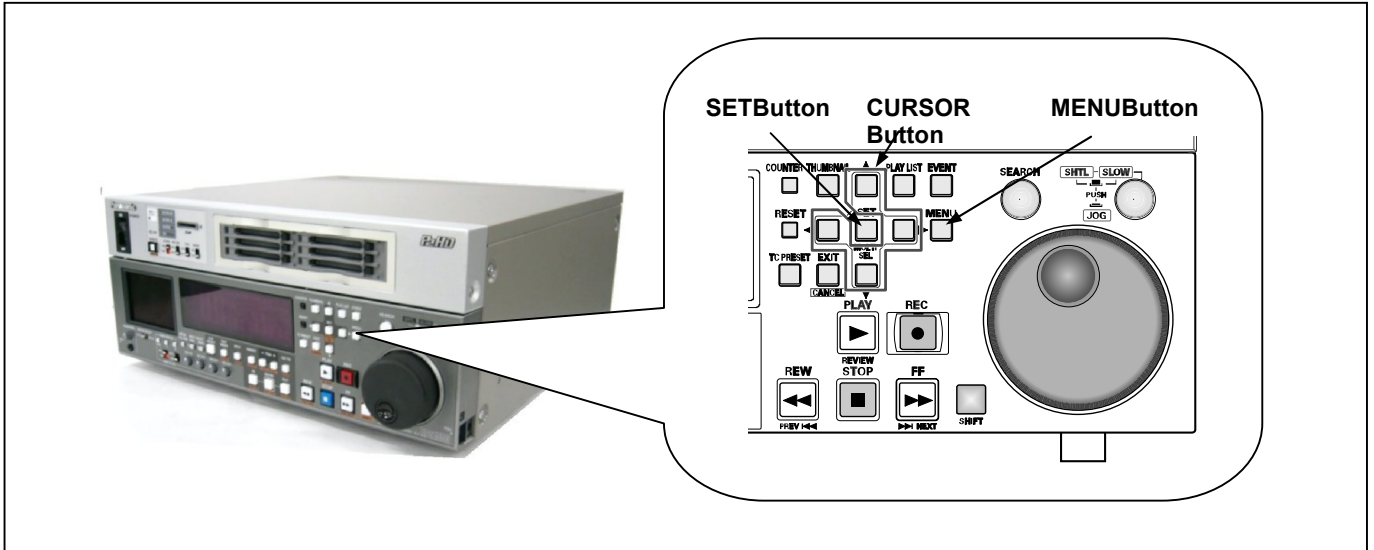

2. Press the **MENU** button to display the menu. Use the **CURSOR** buttons to select the “**PROPERTY**” and press **SET** button to open the PROPERTY menu.

3. Select the item “**SYSTEM INFO**” on the menu and press the **SET** button. The VERSION is displayed like following sample.

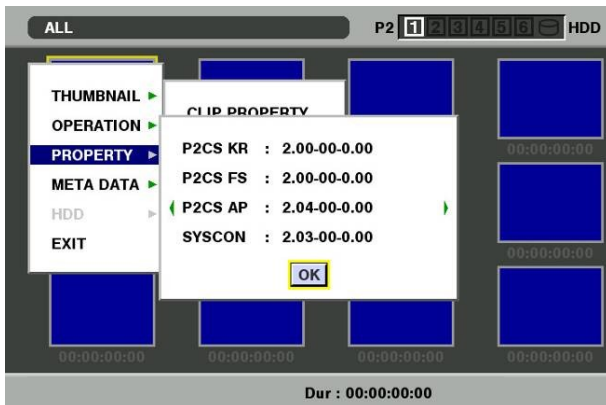

Version Information

Install AJ-YBX200 in AJ-HPS1500.

Installation of AJ-YBX200 in P2 equipments are for use by qualified service personnel only.

1. Press the **THUMBNAIL** button to display the thumbnail screen.

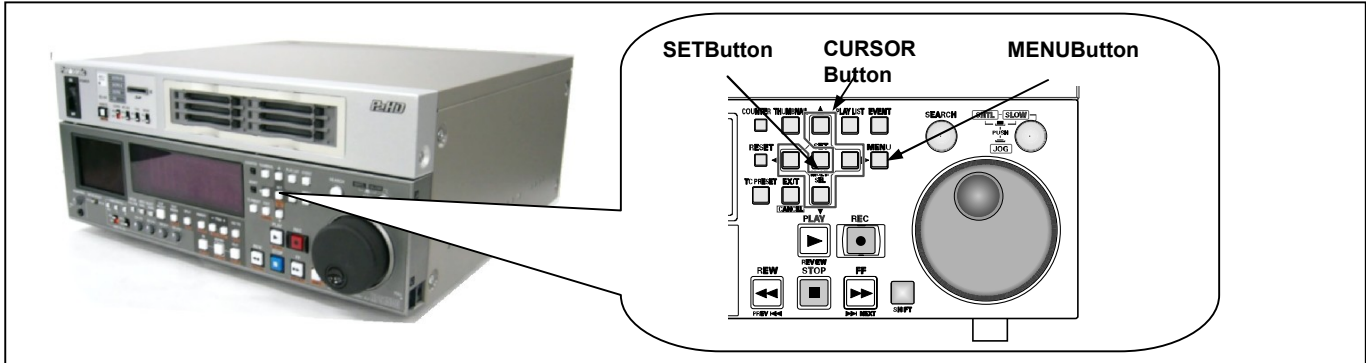

2. Press the **MENU** button to display the menu.
3. Use the **CURSOR** buttons to select the “PROPERTY””SYSTEM INFO”
4. Use the CURSOR buttons to display the following sample.
5. Confirm the version of “AVC-I SOFT”

The version is displayed like sample.

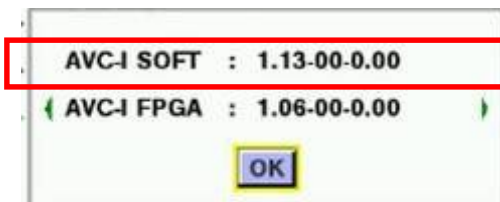

1-1. Summary

1. 1.Copy the update file of the Driver Software (Firmware) to an SD card.
2. 2.Software can be updated using this SD card.

CAUTION: Before Update Software

- Do not power down or pull card while upgrading.

If the program quits during loading, the data will be erased or part writing condition and the restart is not made.

2-2. Preparation

< Preparation for SD Card >

1. SD Card (more than 64MB memory card) is required.(SDHC card is not supported.)
2. Insert an SD card into the P2 equipment and format SD card.

NOTE: SD Card needs to be formatted by P2 equipment. SD card formatted by PC standard formatter will not work.

< Copy of Image data for upgrade >

Copy the update file of Software to the SD card as follows.

1. Download the Software file “**VSI*****.zip**” from the support desk.
<http://pro-av.panasonic.net/en>
 2. Copy the file “**VSI*****.zip**” to the hard disk of your PC and extract the file.
 3. Insert a formatted SD card into the card slot of PC.
 4. Copy **the whole folder “PRIVATE”** in the extracted folder to the SD card.
- NOTE:** Do not change the construction of folder and the file name.

2-3. Updated procedure

1. Insert a formatted SD card into the SD card insertion slot of this recorder.

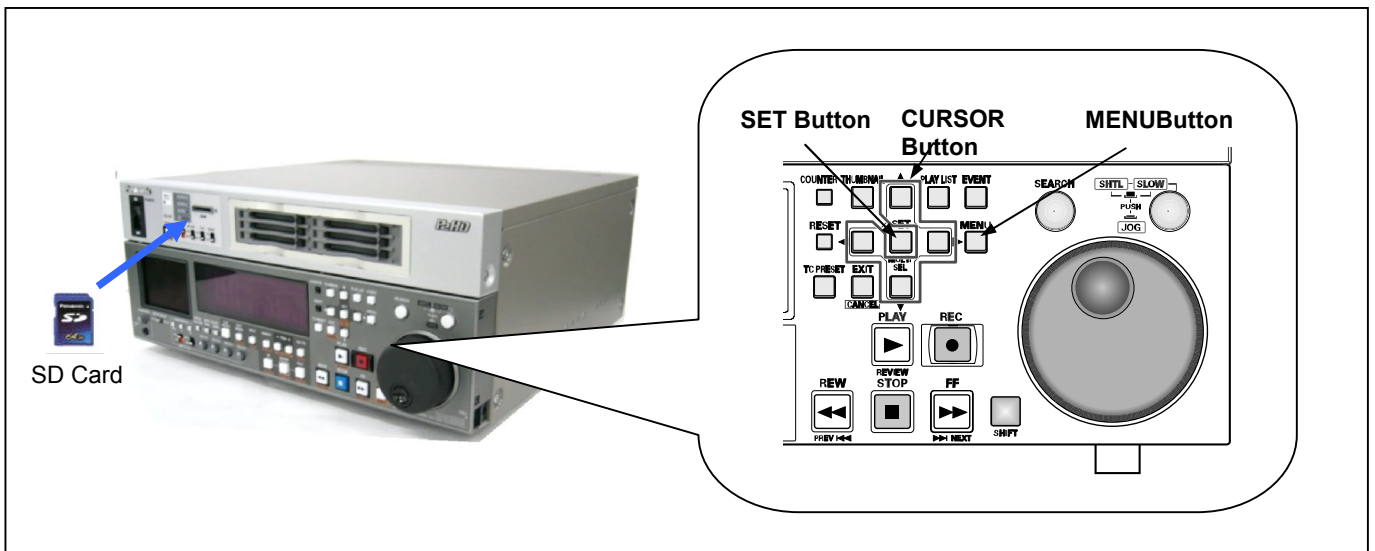

- 2.Press the **TUMBNAIL button** and **MENU button** to display the menu.
Use the **CURSOR buttons** to select the item “**OPERATION**” and press **SET button** to open the OPERATION menu.

3. Select the item **“UPDATE”** on the menu and press the **SET button** (If the update SD card does not insert into the unit, item **“UPDATE”** does not appeared.). The confirmation menu of the execution is displayed. If upgrade is executed, select the item **“YES”** and press **SET button**. In this time, BUSY(operation mode display)lamp is turned off.

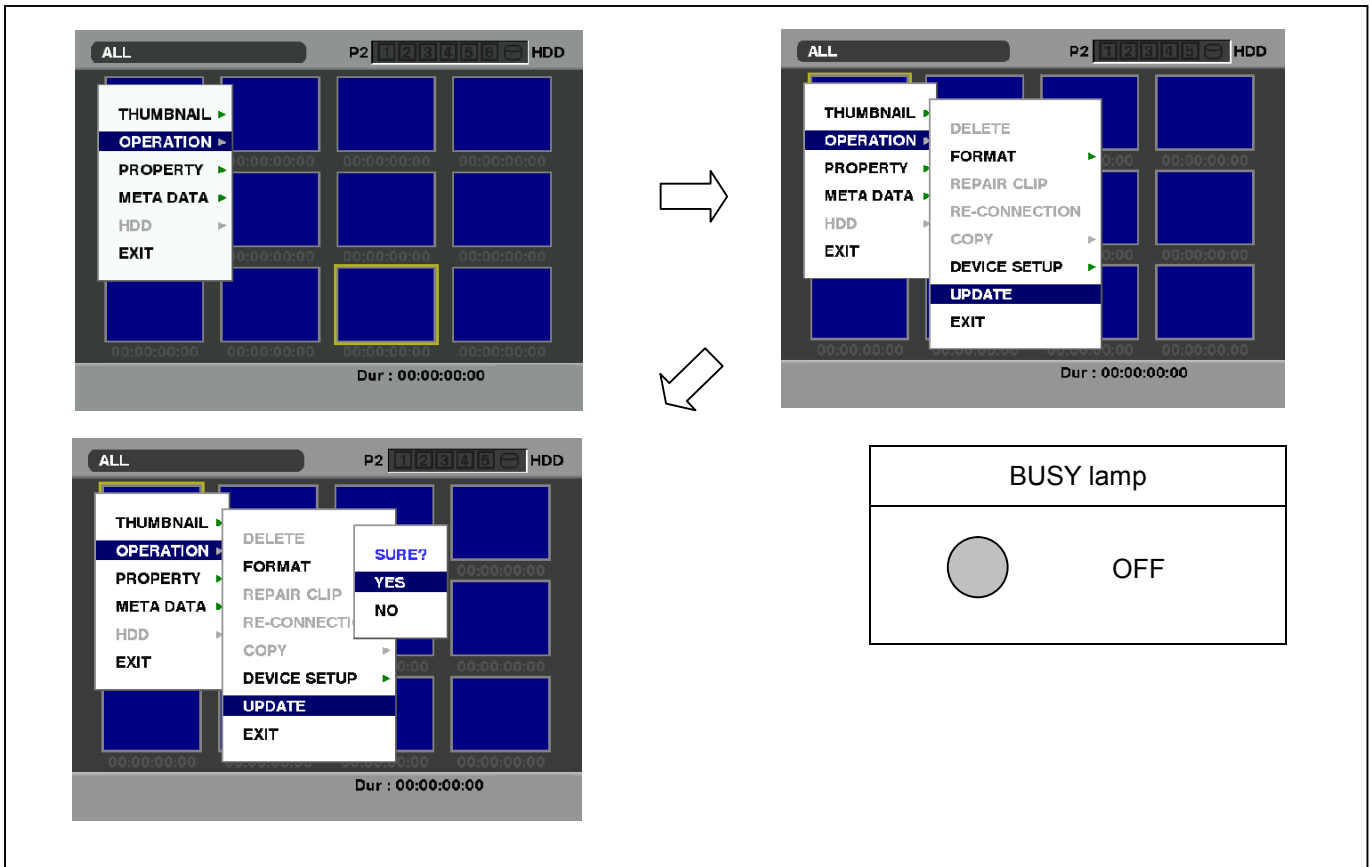

4. Update program is started and the message **“PREPARING FOR UPDATE”** appears on screen. In this timing, it is doing preparation such as the confirmation of the data of the updating. In this time, BUSY(operation mode display)lamp is turned off.

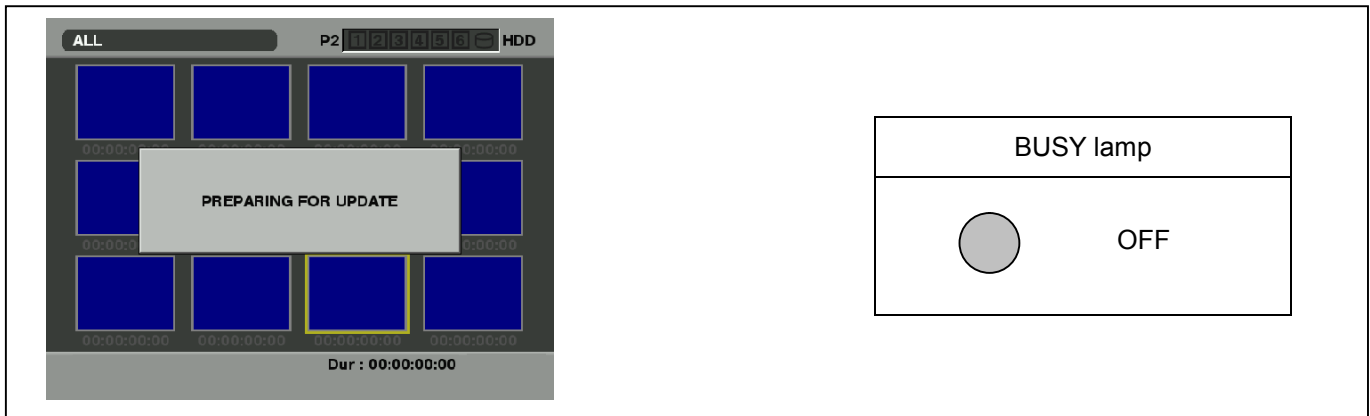

5. When shifting to the update process of the Driver Software (Firmware), following screen is displayed. In this timing, it is doing preparation such as the confirmation of the data of the updating. In this time, BUSY(operation mode display) lamp is flash.

The name of firmware in the update is displayed.

[Firmware Name]

SOFTWARE VERSION UPDATE

(Do not touch!)

Watch the SD Access LED !!

☑ When Flashing : Version Update is in progress

☑ Stuck ON or OFF more than 1 min. : ERROR

In case of ERROR, follow the procedures below.

1. Turn power OFF.
2. Restart version update with newly made update SD and repeat.

BUSY lamp

FLASH

- ◆ Software update takes approx. 15 min.
- ◆ Sometimes the display turn black or blink ,please don't turn power off during updating.

6. In updating succeed, following screen is displayed. Pull out the SD card and turn OFF and ON the unit in order to restart it. In this time, BUSY(operation mode display) lamp is turned off.

[Firmware Name]

Version update successful

Turn power OFF.

BUSY lamp

OFF

NOTE: If the upgrade is not successful, an error message will appear.

VERSION UPDATE ERROR !

To restart version update, keep update SD inserted and power OFF power on again.

Version update will restart automatically in a few minutes when power ON again.

⚡ If the power supply is shut down on the way to update or above error operation is performed, turn the power ON then restart the write function again by the condition to have inserted a SD card.

7. Remove the SD card and turn the power to OFF.