

# AG-AC30 Firmware update procedure

---

## 1. Version display method

### 1-1. The version of system in camera recorder

The version of system in this camera recorder is displayed in MAINTENANCE menu screen.

1. Turn the power on.
2. Press **MENU** button to display the setting menu.
3. Select the MAINTENANCE menu and touch "**MAINTENANCE**" to open the MAINTENANCE menu.
4. Select the item "**VERSION**" (Touch "**VERSION**") to display the version of system in this camera recorder.

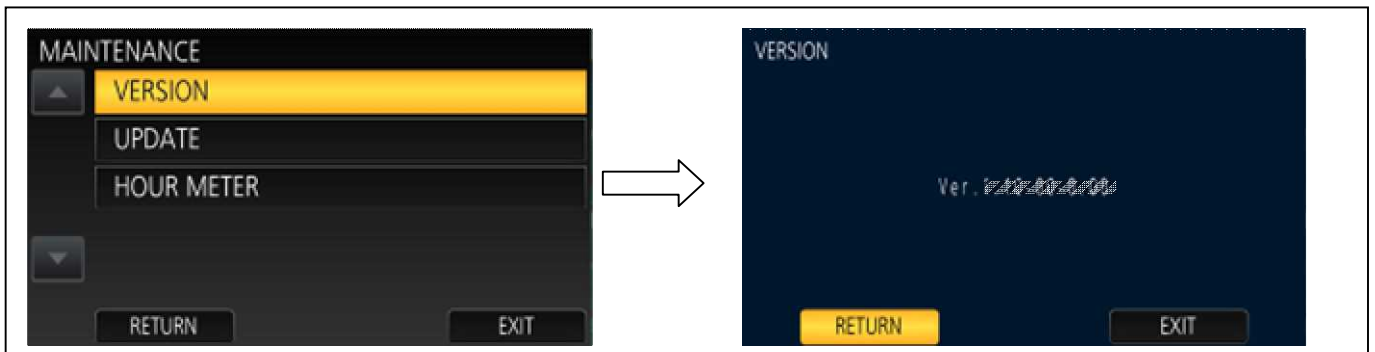

## 1-2. Preparation

### **CAUTION : Before Updating Software**

**Do not power down or pull card while upgrading.** If the program quits during loading, the data will be erased or part writing condition and the restart is not made.

#### **< External Power >**

Please use the AC adapter.

#### **< Preparation for SD memory card >**

1. Buffer memory size in SD memory card more than 4GB (SDXC, SDHC).
2. Use an SD Memory Card which has already been formatted for this unit.

**NOTE:** Be sure to format SD memory card on this unit.

#### **< Copy the update file >**

1. Accept the software usage agreement and download the update file data "**TC58NYG0H16\*.zip**" for the AG-AC30 firmware from the following support web site.

<http://pro-av.panasonic.net/en/>    **Service and Support**

2. Copy the file "**TC58NYG0H16\*.zip**" to hard disk of your PC and extract the file.
3. Insert the formatted SD memory card into the PC's card slot. Then copy the extracted update file "**UPDATE.HDC**" to the root directory(\*1) of the card.

For example, if the SD Card folder is on D ¥drive, the file's location will be described as D ¥UPDATE.HDC.

(\*1): Root directory = top-level directory of the file structure.

## 2. Update procedure

1. Turn the power on. Set the **MODE SW** to **RECORDING** side.
2. Insert the SD memory card into the SD memory card slot 1.
3. Press the **MENU** button to display the setting menu.

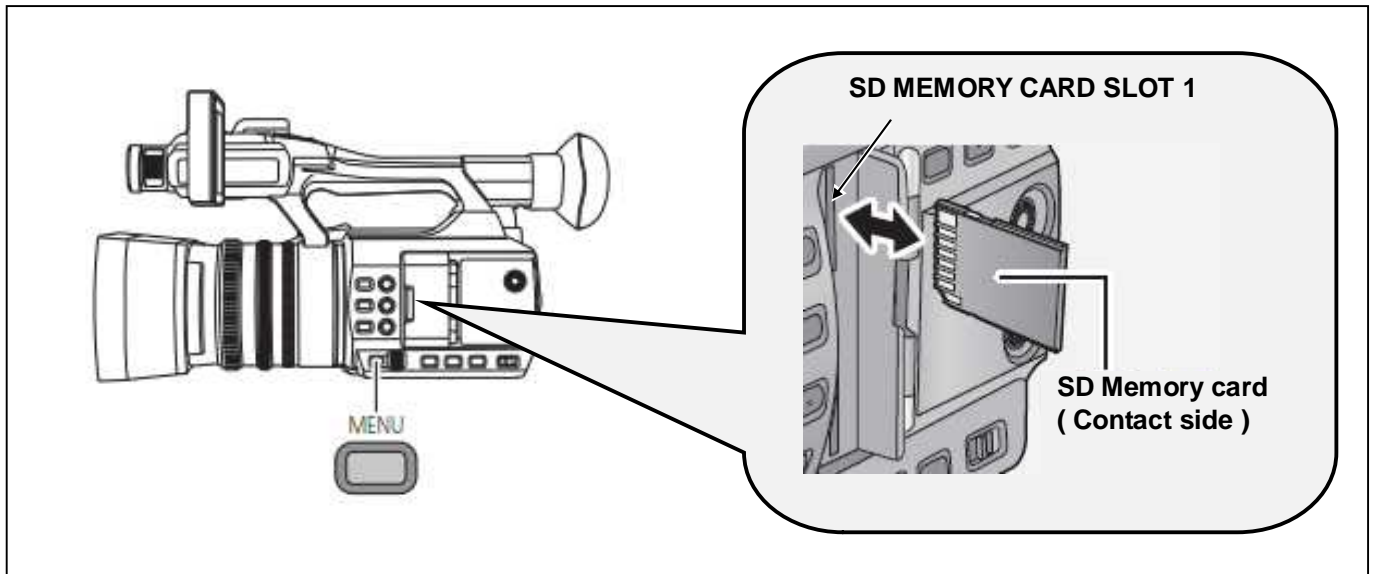

4. Select the item **“UPDATE”** on the MAINTENANCE menu. (Touch **“UPDATE”**.)

**NOTE:** When the update file is not recognized on SD memory card etc., the message **“CHECK CARD.”** is displayed as follows. Please confirm whether the update file is correctly written on the SD memory card.

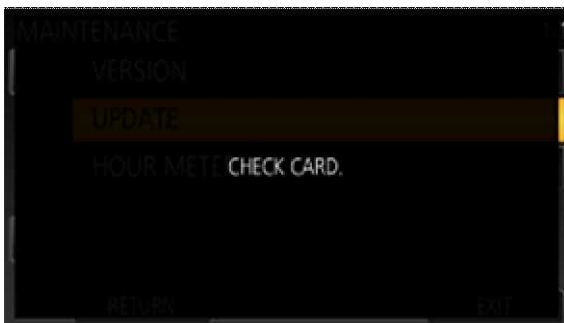

5. It takes a few seconds to check the file. While checking it, the message **“Please wait.”** is displayed. If the update can be executed, the versions of the camera recorder and the update file on the SD card are displayed.

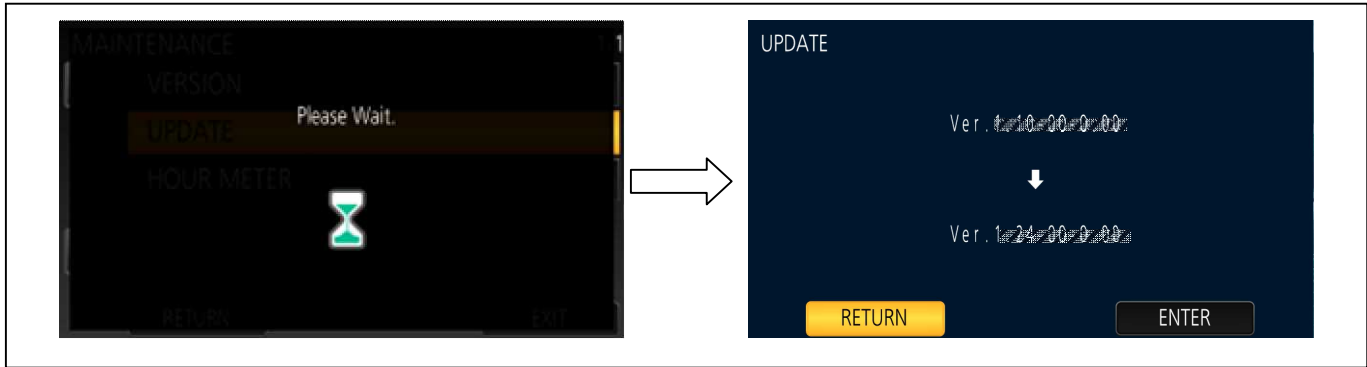

6. Select the **“ENTER”** button. (Touch the **“ENTER”** button.)  
 7. The update confirmation screen is displayed. When **“YES”** is selected, the update process will start. (Touch the **“YES”** button.) When **“NO”** is selected, the screen will return to the OTHER FUNCTION menu screen.

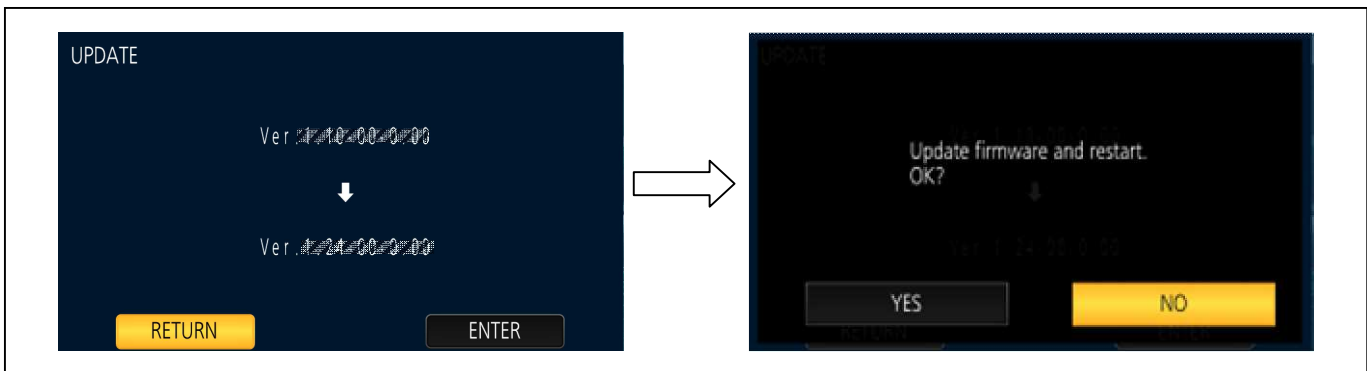

8. The progress bar appears in LCD screen when shifting to the update processing.

◆ Software update takes approx. 1 to 2min. Do not power down while updating.

9. When the update is completed, the power automatically turns OFF / ON and the message **“Update is completed.”** is displayed. After the power is ON again, **Status indicator is ON.**
10. Select the **“OK”** button. (Touch the **“OK”** button.) The normal **“Recording”** mode screen is displayed.



**< How to recover from irregular situations while updating >**

Solutions are introduced against both Card Plug-Out and Power Interruption troubles to execute the update again.

Process	Card Plug-Out	Power Interruption
Data Readout from SD Card	The process of Update is stopped.	The camera recorder starts up normally. Restart from selection of <b>“UPDATE”</b>
Updating (Update of Flash ROM Data)	Plug-Out is ignored. Update is continued. (because the update file data is already transferred to the camera recorder)	At the power-on, the camera recorder starts up in <b>UPDATE</b> mode. Update is continued.

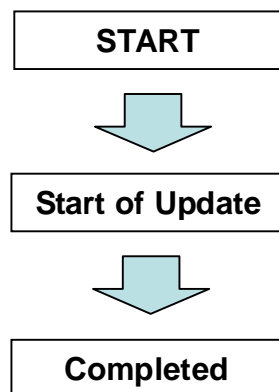

**3. Confirm the version number is renewed**

Follow the procedure of **“Step1”**, confirm the version number is renewed.

If it succeeded to update, the update file in the SD memory card is not need anymore.