

Firmware update procedure

AU-V35LT1G/ AU-V35LT1MC (Varicam LT)

1. How to check firmware version

1. Connect Camera module to Recording module. Switch ON the power of the camera recorder.
2. Press **MENU** button. Select "> **SYSTEM SETTINGS** >**INFORMATION** >**VERSION**" to display the current version with the **Jog Dial** button.

The image shows a screenshot of the camera's system settings menu. The menu is displayed on a black background with white text. The top-left section shows the following information:

MODEL	: AU-V35LT1G
SERIAL NO.	: C6TAA0003
PRODUCT VERSION	: **.**-00-0.00

A red arrow points to the 'PRODUCT VERSION' line, which is also enclosed in a red box. To the right of this section is another section with the following information:

AVIO FPGA	: 1.01-00-0.00
AVIO-PR FPGA	: 1.00-00-0.00
RX1	: 1.05-00-0.00
CODEC-M0	: 1.00-00-0.00
CODEC-M1	: 1.00-00-0.00
CODEC-SYB	: 1.00-40-0.00

Below these sections are two more sections, each with a small triangle icon above it. The bottom-left section shows:

TA0 FPGA	: 1.01-00-2.17
TA1 FPGA	: 1.01-00-2.17
RX0	: 1.04-00-0.00
P2CS BL2-1	: 1.00-00-0.00
P2CS BL2-2	: 1.00-00-0.00
P2CS KR	: 1.00-00-0.00
P2CS AP	: 1.05-00-0.00
VUP	: 1.00-00-0.00
VUP FS	: 1.05-00-0.00

The bottom-right section shows a physical view of the camera's control panel. The **MENU** button and the **Jog Dial** button are circled in red. Arrows point from the labels 'MENU button' and 'Jog Dial button' to their respective locations on the camera's control panel.

The version is displayed like sample

2. Preparation

Prepare following equipment and a firmware package prior to update.

Name	Qty	Remark
SD memory card	1	MAX 64GB MIN 256MB
Firmware package (VSI****.zip)	1	Can be downloaded at: http://panasonic.biz/sav/pass_e
AC adaptor	1	
Computer (PC/Mac)	1	Needed for downloading, unzipping, copying firmware package

⚠ Important: Please read before performing update:

- Update work may take approximately 60 minutes, use secure power supply (AC adaptor), unexpected shutdown while in update may cause an unrecoverable failure.
- Do NOT eject SD memory card while update is in progress (while access LED blinks), interrupting communication between SD card and equipment may cause unrecoverable failure.

**Busy lamp
(Card Slot Access LED)**



SUB SLOT MAIN SLOT

3. Updating firmware

[Preparation]

1. Insert an SD memory card into the SUB SLOT on the unit.
2. Format the SD card (MENU : SYSTEM SETTINGS > CARDS/MEDIA > FORMAT CARD > SD CARD)
3. Visit Panasonic professional video support website <http://panasonic.biz/sav/pass_e> and download "vsi*****.zip" firmware package.
4. Extract the ZIP package (you will see "PRIVATE" folder).
5. Mount the formatted SD card to the computer then copy the **"PRIVATE"** folder to the SD card.



[Perform update]

6. Insert the SD card into the SUB SLOT on the unit.
7. Disconnect the cable between the viewfinder and the camera body.
8. Press **INFO** button to display INFO screen. Press the operation button of **VERSION** and press the Jog Dial.

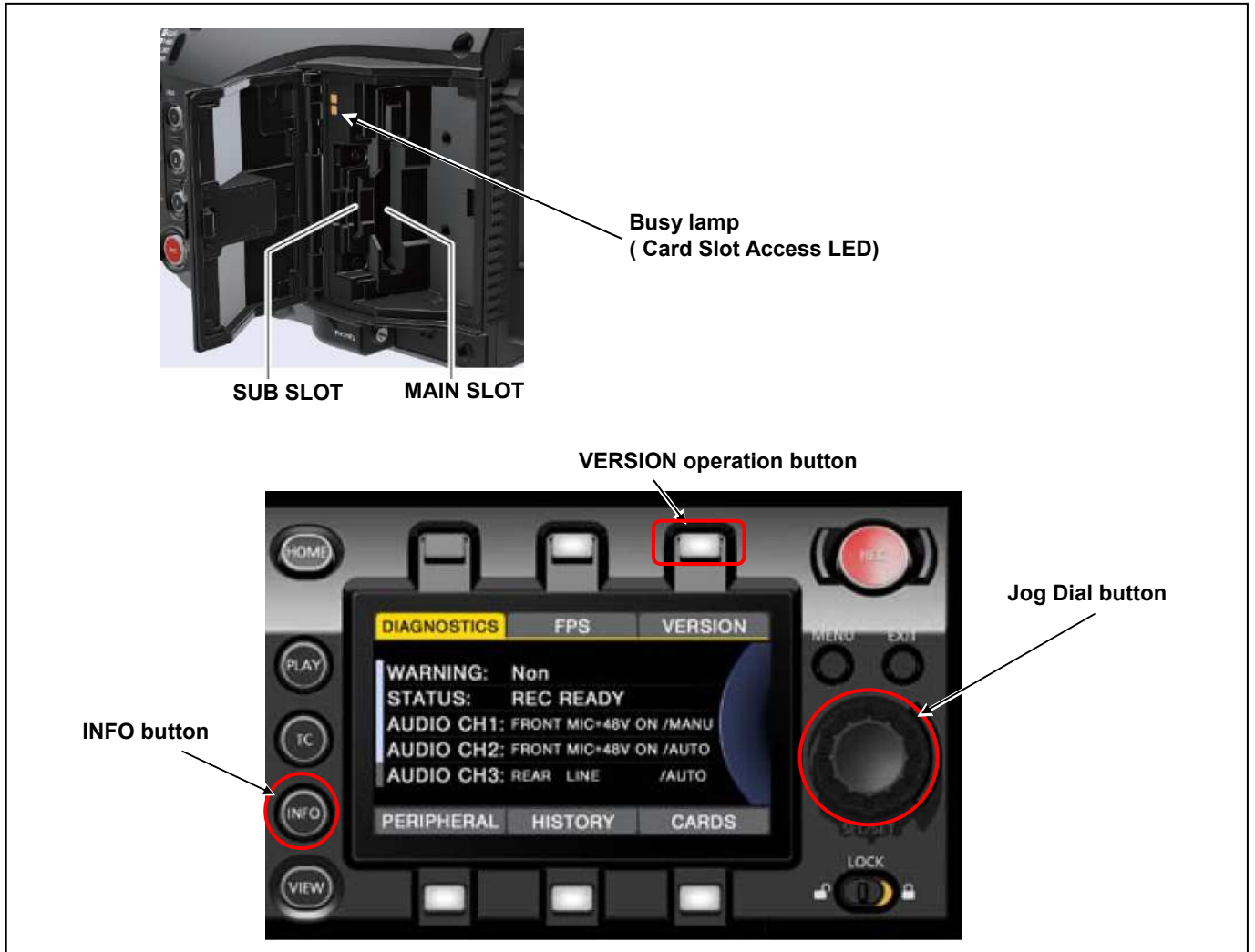

9. When “**UPDATE**” menu item appears, press the operation button of **UPDATE > OK**



10. Wait until the “**Version update successful**” dialog is displayed.

It may take **approximately 60 minutes (Maximum)**.

11. Remove the SD card.
12. Switch OFF the power, and disconnect and connect DC power > switch ON the power to complete.
13. Make sure the firmware version.



MENU:
SYSTEM SETTINGS > INFORMATION > VERSION

4. Troubleshooting

1. Update is failed with VERSION UPDATE ERROR! (ERR5)



Check points

- Is the folder name in the SD memory card surely “private”? Its folder name may often be renamed by computers automatically when downloaded and unzipped the package (example: renamed to private-2). In this case, rename it to “private” and try again.
- Is the directory of the firmware package correct as shown below?

SD memory card ▶ private ▶ meigroup ▶ pavcn ▶ sbg ▶ p2sd ▶ fw ▶ vsi****.pkg
- Is the firmware surely for the VARICAM LT (AU-V35LT1G)?